

SPECIFICATIONS	Model	LB-800									
		LB-series 0.75kW, 1-phase									
<p><b>Type of Pump</b> Submersible drainage pump for construction and foundation works, floodwater drainage, etc.</p> <p><b>Type of Fluid</b> Stormwater, groundwater, wash water, and sand-carrying water</p> <p>Temperature: 0 to 40°C</p> <p><b>Discharge Bore &amp; Connection</b> 50mm, Hose Coupling (80mm discharge bore available on special request)</p> <p><b>Motor Output</b> 0.75kW</p> <p><b>Power Supply</b> Single-phase</p> <p><b>Starting Method</b> Capacitor Run</p> <p><b>Motor</b> Continuous-duty rated, dry-type induction motor</p> <p>Insulation Class: E Degree of Protection: IP68</p> <p>No. of Poles &amp; Speed (Synchronous Speed) 2-pole, 3000/3600min<sup>-1</sup> (50/60Hz)</p> <p>Power Supply Voltages &amp; Rated Currents</p> <table border="0"> <tr> <td>50Hz</td> <td>60Hz</td> </tr> <tr> <td>220V – 5.2A</td> <td>110V – 10.1A</td> </tr> <tr> <td>230V – 5.0A</td> <td>220V – 5.3A</td> </tr> <tr> <td>240V – 4.7A</td> <td></td> </tr> </table> <p><b>Power Cable</b> Sheath: PVC Standard Length: 5m 200 to 240V supply: 1 x 3 x 1.25mm<sup>2</sup>, O.D. 10.1mm 100 to 120V supply: 1 x 3 x 2.0mm<sup>2</sup>, O.D. 10.9mm</p> <p><b>Dry Weight</b> (excluding cable) 13.1kg</p>		50Hz	60Hz	220V – 5.2A	110V – 10.1A	230V – 5.0A	220V – 5.3A	240V – 4.7A		<p><b>Impeller</b> Vortex impeller deigned for “high-gap structure”, made of urethane rubber</p> <p>Solids Passage 50Hz – ϕ6mm 60Hz – ϕ6mm</p> <p><b>Cable Entry with Anti-Wicking Block</b> Watertight cable entry with strain-relief device. The anti-wicking block prevents water incursion due to capillary action should the power cable be damaged or the end submerged.</p> <p><b>Bearing</b> Permanently lubricated, deep-groove, double-shielded C3 ball bearings</p> <p><b>Shaft</b> 403 stainless steel</p> <p><b>Shaft Seal (Mechanical Seal)</b> Furnished with a double-face mechanical seal located in oil chamber. Both upper and lower seal faces always run in a clean environment.</p> <p>Upper Seal Face: Ceramic + Carbon Lower Seal Face: SiC + Ceramic</p> <p><b>OIL LIFTER (Patented)</b> Equipped in oil chamber. It forcibly supplies lubricating oil to the mechanical seal and continues to supply the oil to the upper seal faces even if lubricant falls below the rated volume.</p> <p>Type of Lubricating Oil &amp; Volume Turbine Oil (ISO VG32), 155ml</p> <p><b>Motor Protection Device</b> A circle thermal protector built in the motor housing. Directly cuts the motor circuit if excessive heat builds up or an overcurrent condition occurs in the motor.</p>	
50Hz	60Hz										
220V – 5.2A	110V – 10.1A										
230V – 5.0A	220V – 5.3A										
240V – 4.7A											

NO. A-21590-1

# PUMP PERFORMANCE CURVES

TYPE Submersible Portable Pump	MODEL LB (Z) -800 -52 LB -800A -52	FREQUENCY 50 Hz
-----------------------------------	--	--------------------

CUSTOMER'S NAME \_\_\_\_\_

EQUIPMENT TITLE \_\_\_\_\_ NO. \_\_\_\_\_

	STANDARD SPECIFICATIONS	REQUIRED SPECIFICATIONS
DISCHARGE BORE	50/80 mm	mm
TOTAL HEAD	MAX. 15 m	m
CAPACITY	MAX. 0.31 m <sup>3</sup> /min	m <sup>3</sup> /min
MOTOR OUTPUT	0.75 kW	kW
PHASE x VOLTAGE	1 $\phi$ x V	$\phi$ x V
CURRENT	A	A
POLES / REVOLUTION	2 P / S. S. 3000 min <sup>-1</sup>	P / min <sup>-1</sup>
STARTING METHOD	CAPACITOR MOTOR	
INSULATION CLASS	E	

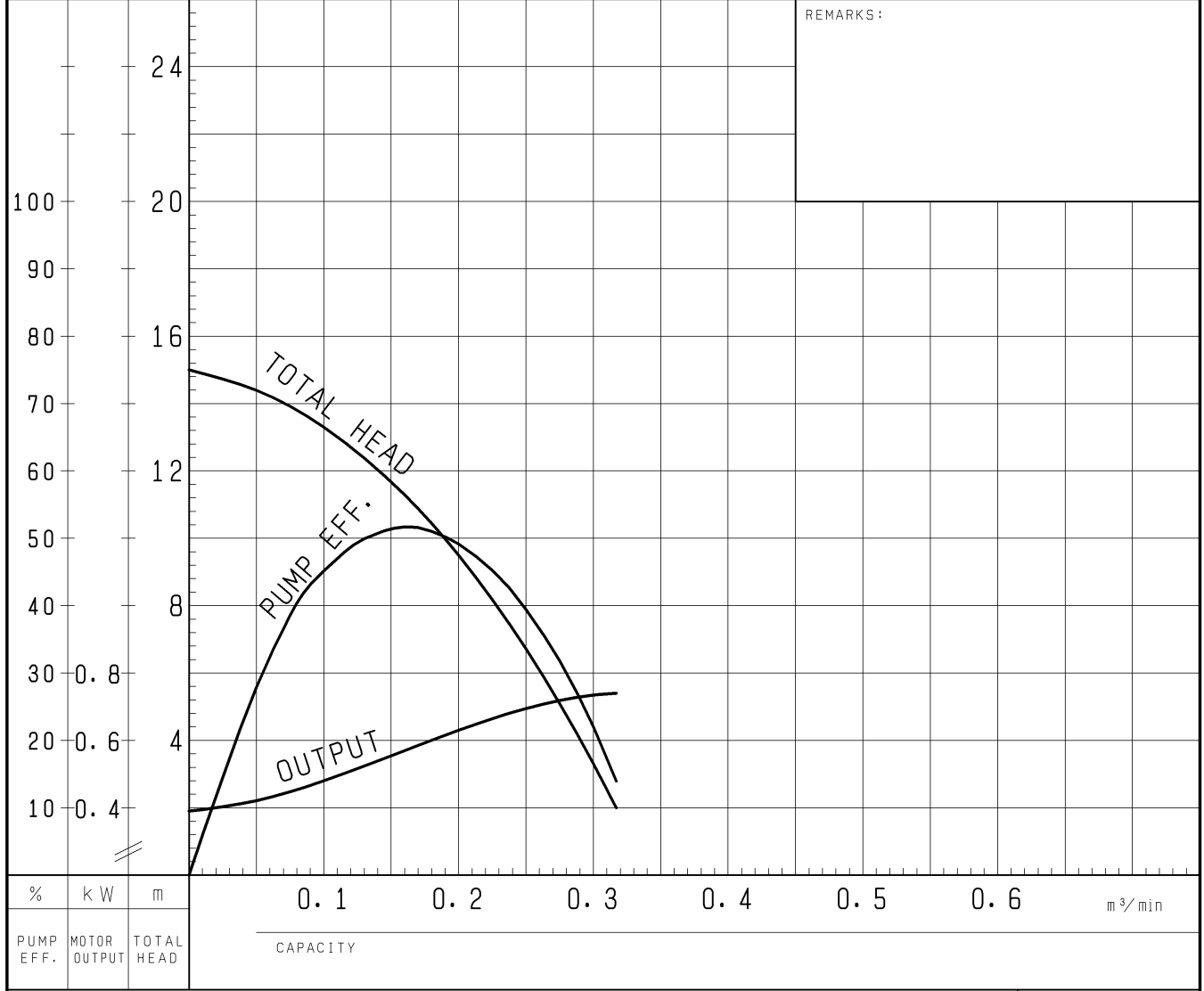

TSURUMI MFG. CO., LTD.

DIMENSION DRAWING		No.	No. A-21594-1
TYPE	Submersible Portable Pump	MODEL	LB-800 -52/62

Approximate Weight (※)
13.1kg
(13.3kg)
※excluding cable

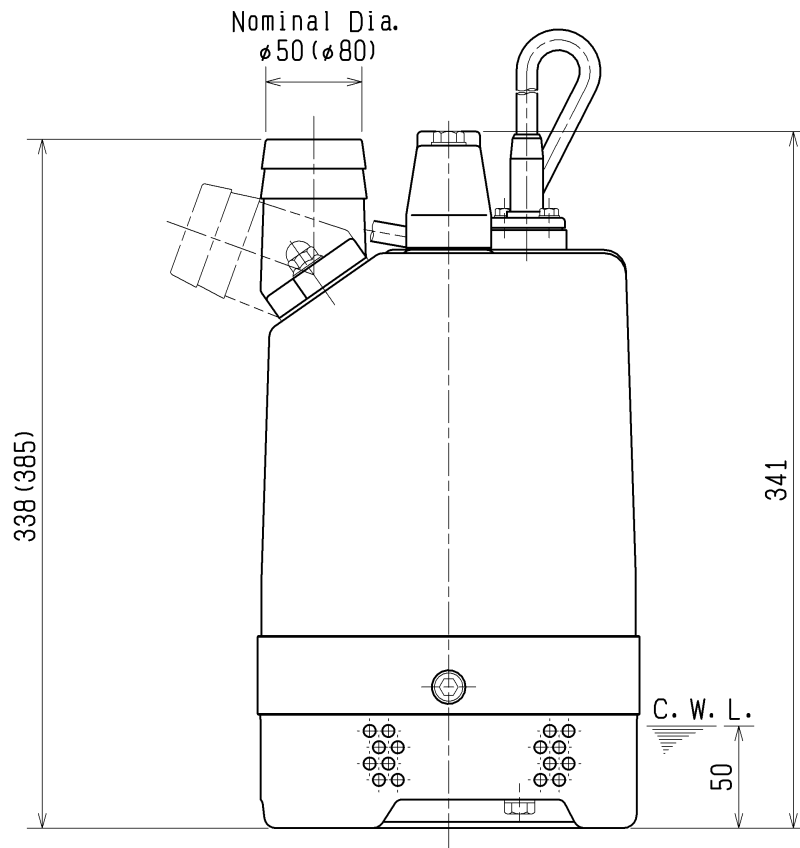
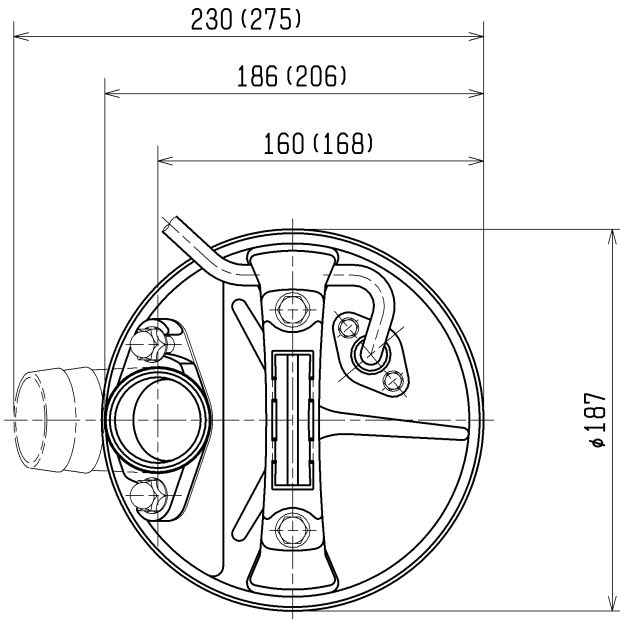

The Figure in ( ) shows the dimensions of discharge Bore at Nominal  $\phi 80$ .

C.W.L. :Continuous running Water Level

<b>SECTIONAL DRAWING</b>		No.	No. A-21597-1
TYPE	Submersible Portable Pump	MODEL	LB-800 -52/62

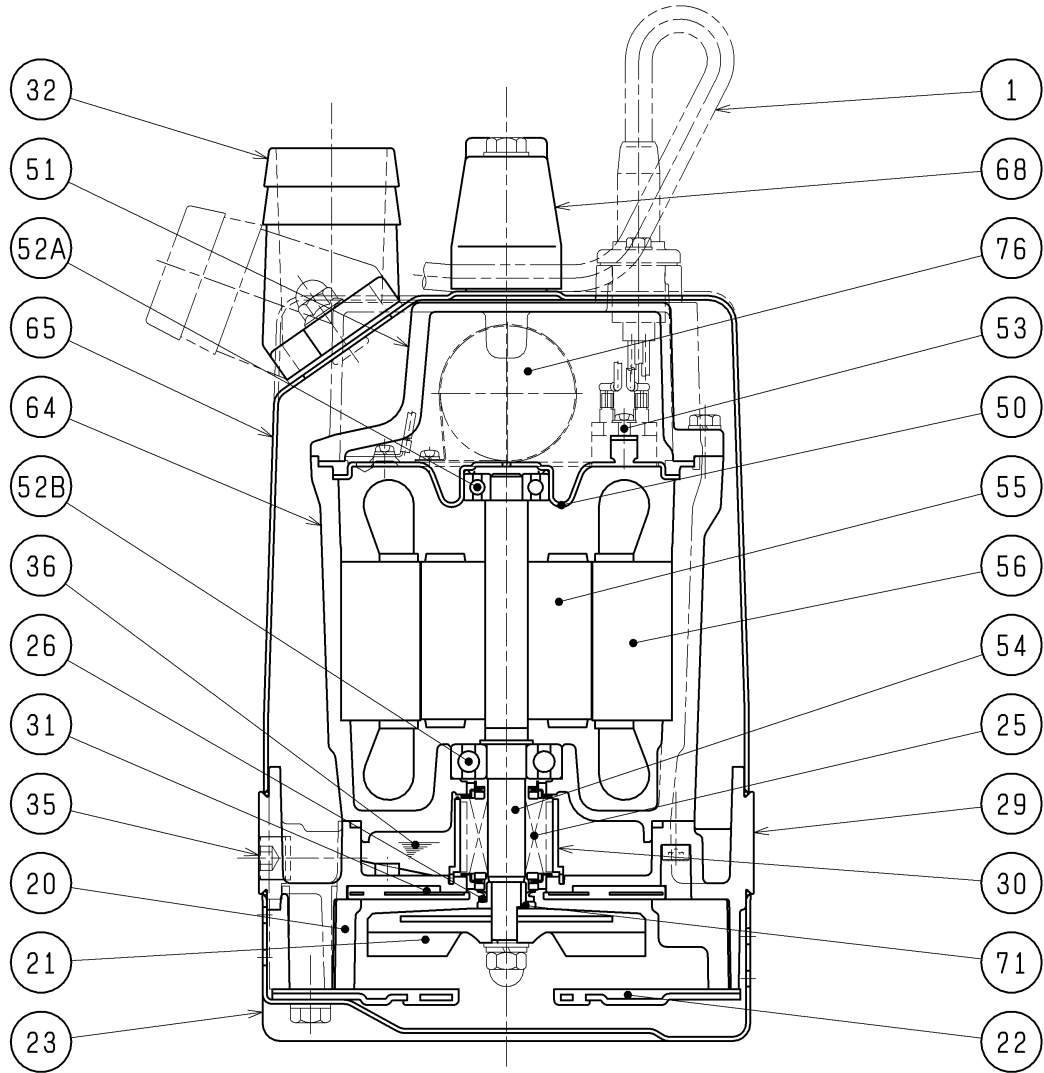

REQ. SPECIFICATION

No.	DESCRIPTION	Q'TY	MATERIAL / NOTE	No.	DESCRIPTION	Q'TY	MATERIAL / NOTE
1	Cabtyre Cable	1	PVC Sheath	51	Motor Head Cover	1	Aluminium Die Casting
20	Pump Casing	1	Butadiene Rubber + Natural Rubber	52A	Upper Bearing	1	6201ZZC3
21	Impeller	1	Urethane Rubber	52B	Lower Bearing	1	6302ZZC3
22	Suction Cover	1	Steel Sheet + Urethane Rubber	53	Motor Protector	1	
23	Strainer Stand	1	Steel Sheet	54	Shaft	1	Stainless Steel 403
25	Mechanical Seal	1	W-14VC	55	Rotor	1	
26	V-ring	1	Nitrile Butadiene Rubber	56	Stator	1	
29	Oil Casing	1	Aluminium Die Casting	64	Motor Frame	1	Aluminium Die Casting
30	Oil Lifter	1	Plastic	65	Outer Cover	1	Steel Sheet
31	Wearing Plate	1	Urethane Rubber	68	Handle	1	Plastic
32	Hose Coupling	1	Aluminium Die Casting	71	Shaft Sleeve	1	Stainless Steel 304
35	Oil Plug	1	Stainless Steel 304	76	Capacitor	1	
36	Lubricant		Turbine Oil (ISO VG32)				
50	Motor Bracket	1	Steel Sheet				